

EK-R100E-IN-001



Installation Guide

digital equipment corporation

First Edition, September 1983

© Digital Equipment Corporation. All Rights Reserved.

The information in this document is subject to change without notice and should not be construed as a commitment by Digital Equipment Corporation. Digital Equipment Corporation assumes no responsibility for any errors that may appear in this document.

WARNING: The Rainbow computer has been certified to comply with the limits for a Class B computing device, pursuant to Subpart J of Part 15 of FCC rules. Only peripherals (computer input/output devices, terminals, printers, etc.) certified to comply with the Class B limits may be attached to this computer. Operation with noncertified peripherals is likely to result in interference to radio and television reception.

This equipment generates and uses radio frequency energy and if not installed and used properly, that is, in strict accordance with the manufacturer's instructions, may cause interference to radio and television reception. It has been type tested and found to comply with the limits for a Class B computing device in accordance with the specifications in Subpart J of Part 15 of FCC Rules, which are designed to provide reasonable protection against such interference in a residential installation. However, there is no guarantee that interference will not occur in a particular installation. If this equipment does cause interference to radio or television reception, which can be determined by turning the equipment off and on, the user is encouraged to try to correct the interference by one or more of the following measures:

- reorient the receiving antenna
- move the computer away from the receiver
- plug the computer into a different outlet so that computer and receiver are on different branch circuits.

If necessary, the user should consult the dealer or an experienced radio/television technician for additional suggestions. The user may find the following booklet prepared by the Federal Communications Commission helpful:

How to Identify and Resolve Radio-TV Interference Problems

This booklet is available from the US Government Printing office, Washington, DC 20402, Stock No. 004-000-00345-4.

The manuscript for this book was created using a DIGITAL Word Processing System and, via a translation program, was automatically typeset on DIGITAL's DECset Integrated Publishing System. Book production was done by Educational Services Development and Publishing in Marlboro and Bedford, MA.

The following are trademarks of Digital Equipment Corporation:

digital	DIBOL	RSX
DEC	MASSBUS	UNIBUS
DECmate	PDP	VAX
DECsystem-10	P/OS	VMS
DECSYSTEM-20	Professional	VT
DECUS	Rainbow	Work Processor
DECwriter	RSTS	

Printed in U.S.A.

Contents

Welcome to the Rainbow Computer	v
Unpacking	1
Installation.....	7
Testing	23
What to Do Next	29
Packing Notes.....	33

Welcome to the Rainbow Computer

Congratulations on purchasing the Rainbow™ personal computing system. The Rainbow computer is today's most versatile industry-standard computer built to Digital's quality specifications and backed by Digital's commitment to service and support. The Rainbow computer is a sound investment in personal productivity that you'll enjoy using every day.

To get you started, we have prepared a set of easy-to-use documentation. In the back of each of these volumes is a card that welcomes your comments. We would like to hear from you.

Remember that purchasing your first Rainbow computer is just the beginning of your relationship with Digital Equipment Corporation, the largest minicomputer company in the world. Our dedication to quality manufacturing, our extensive availability of spares and accessories, and our service organization of 16,000 representatives worldwide are your further assurance of total Digital quality. You have an investment that will grow in value as you use it now and in the future.

Welcome to the Rainbow Computer

This manual provides the procedures to unpack and install your Rainbow computer. You can place its components in a variety of locations. An optional floor stand is available for your system unit.

You do not have to know anything about computers to install the Rainbow computer. Just follow the steps in sequence. Allow one hour or more for the installation.

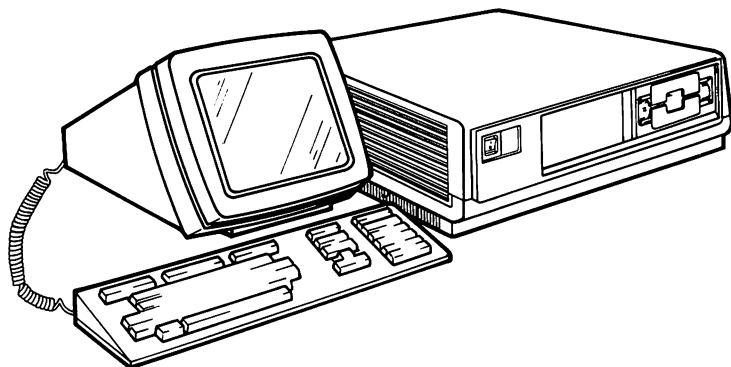

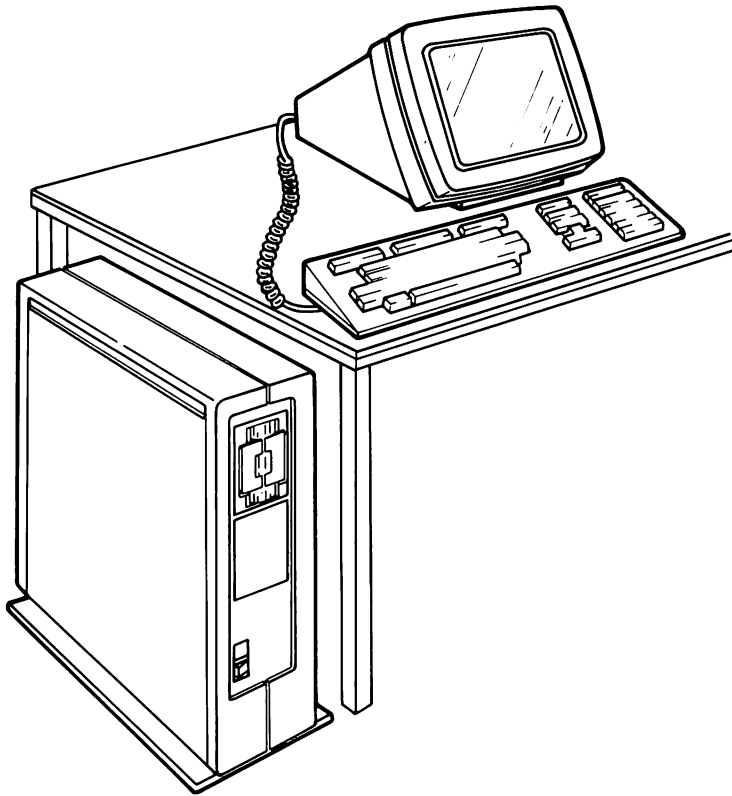

Unpacking

Identify boxes.

If any boxes or items inside the boxes are missing or damaged:

- Contact your salesperson or the retail store, and
- Contact the delivery agent.

IMPORTANT

Save the opened boxes and all the packing material in case you need to return an item for any reason.

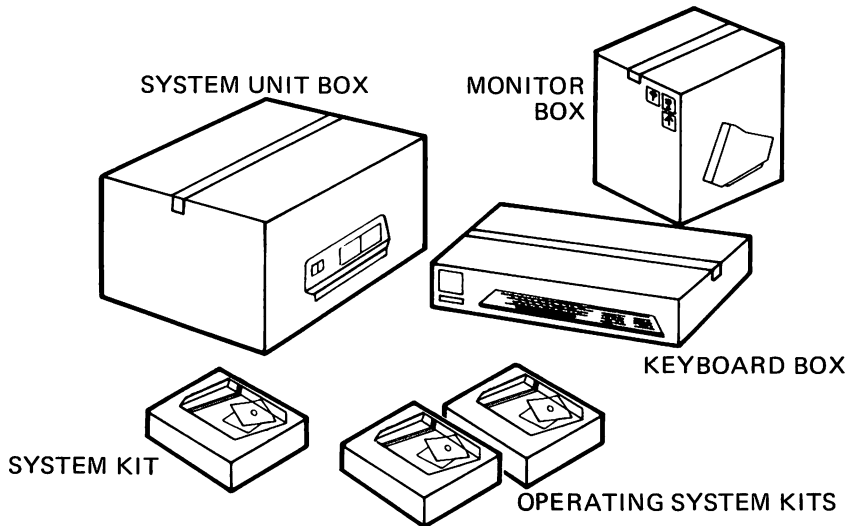

NOTE

You may have boxes of optional equipment that are not shown here.

Check the contents of the system kit.

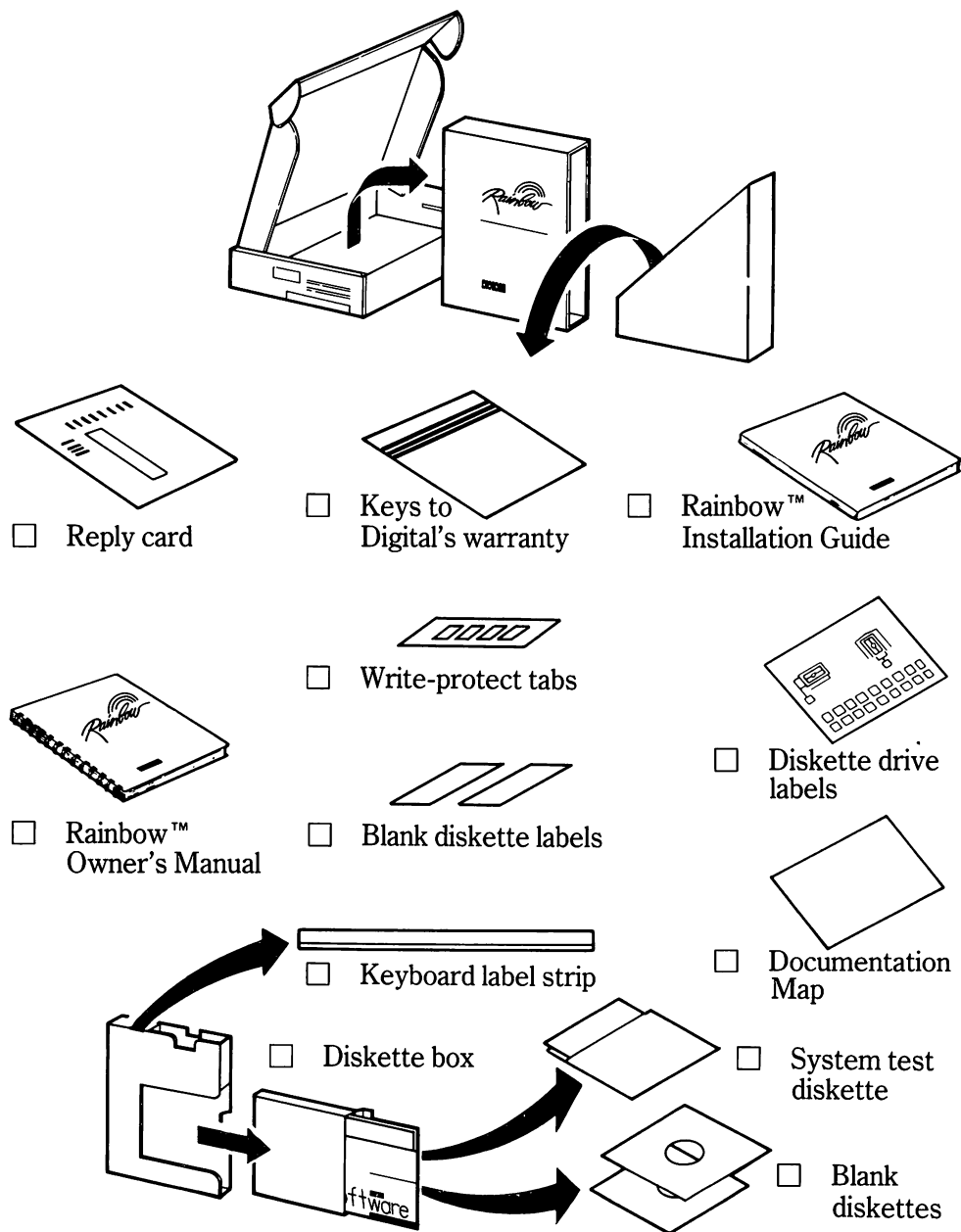

Unpack the system unit box.

- System unit

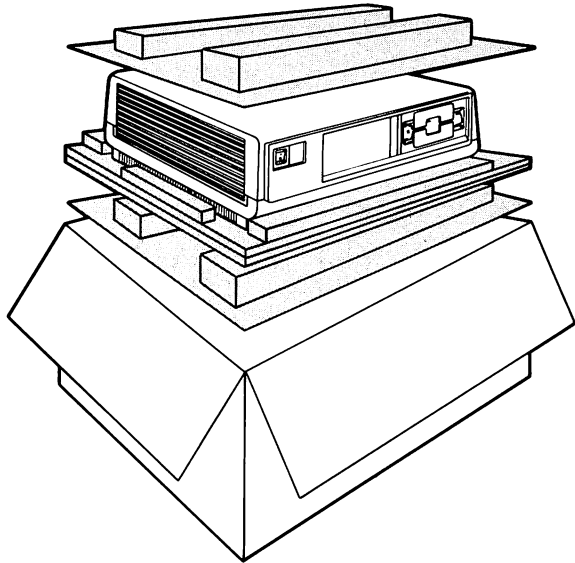

- Monitor cable



- Printer/communications cable



NOTE

Place the system unit near a wall receptacle.

Unpack the monitor box.

- Monitor

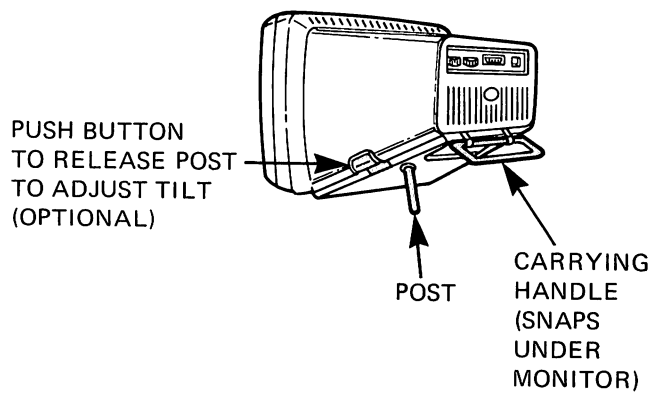
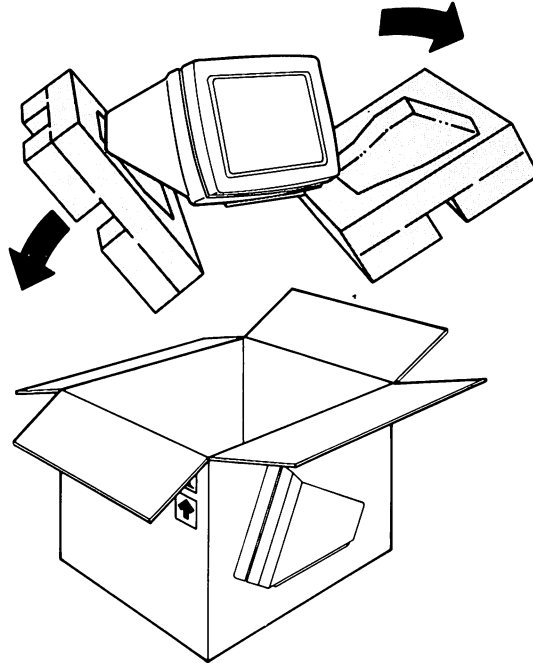

Unpack the keyboard box.

- Keyboard

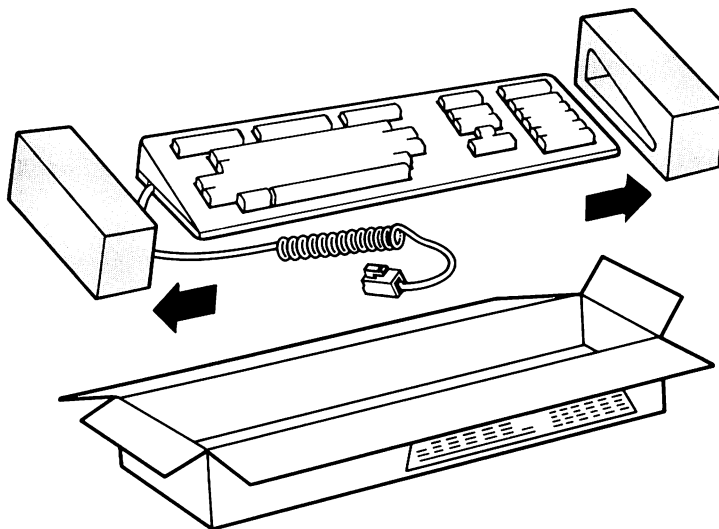

- Power cord

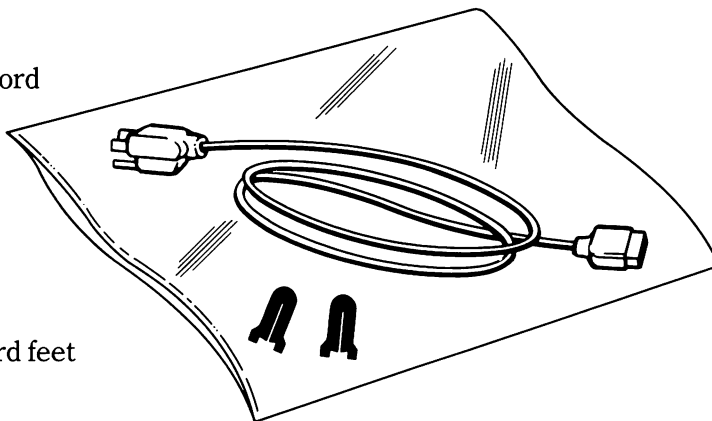

- Keyboard feet

Installation

If you need help at any time, call the appropriate Digital Customer Help Line number listed on page 27.

CAUTION

DO NOT plug in the power cord until you are directed to do so.

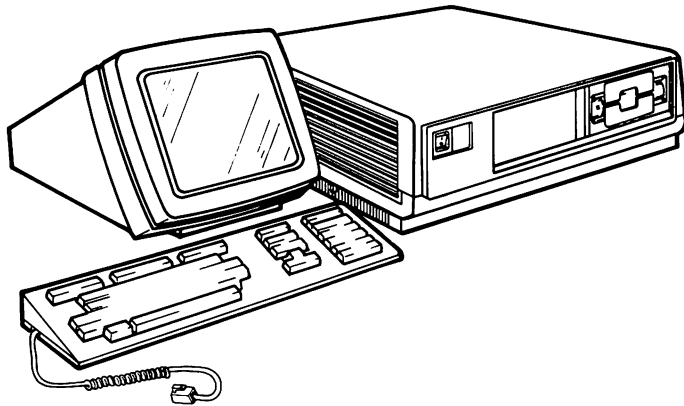

Install the keyboard feet (optional) and the label strip.

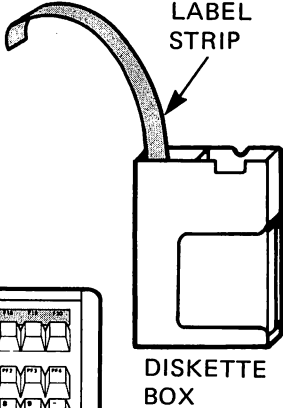
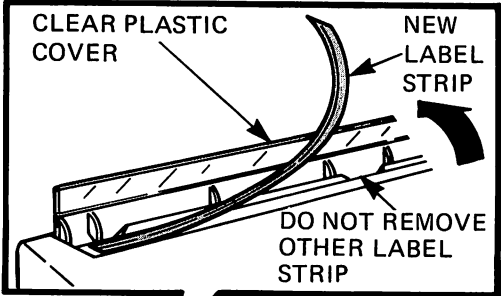
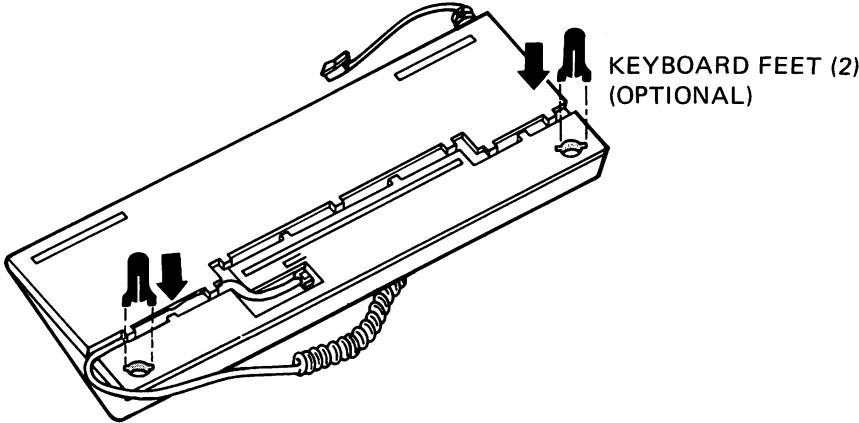

Connect the keyboard to the monitor.

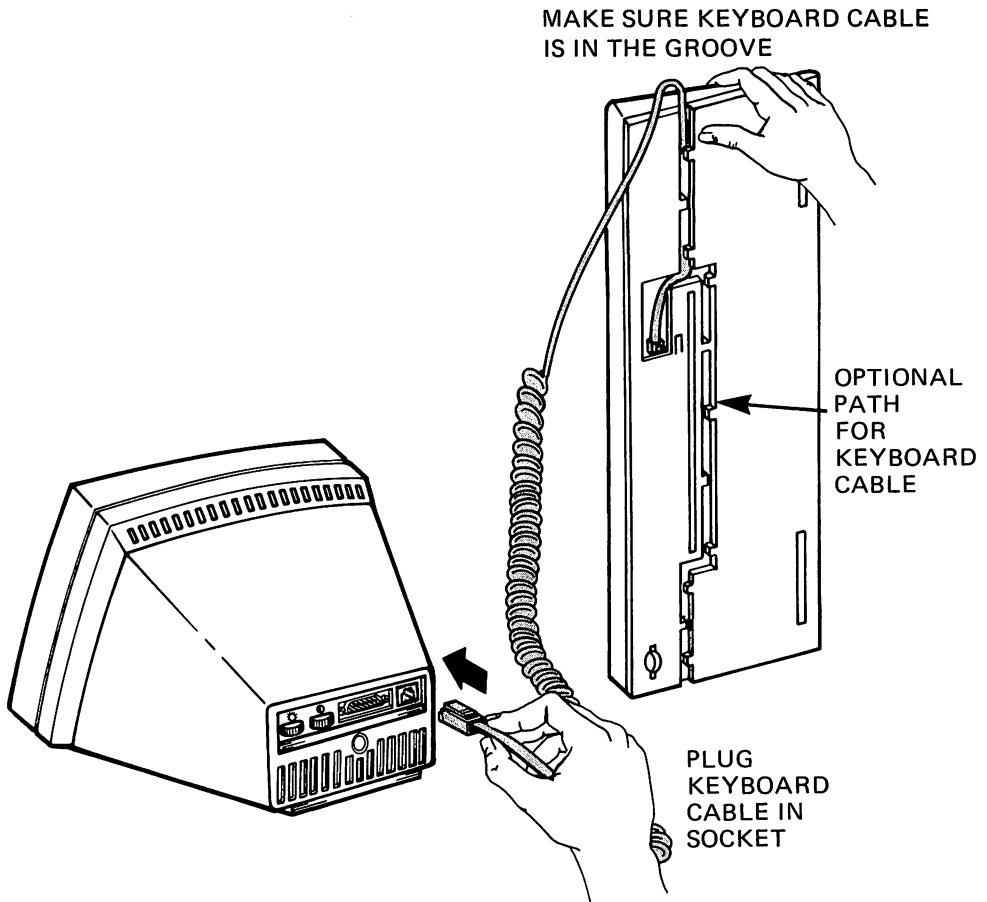

Connect the monitor cable to the monitor and to the system unit.

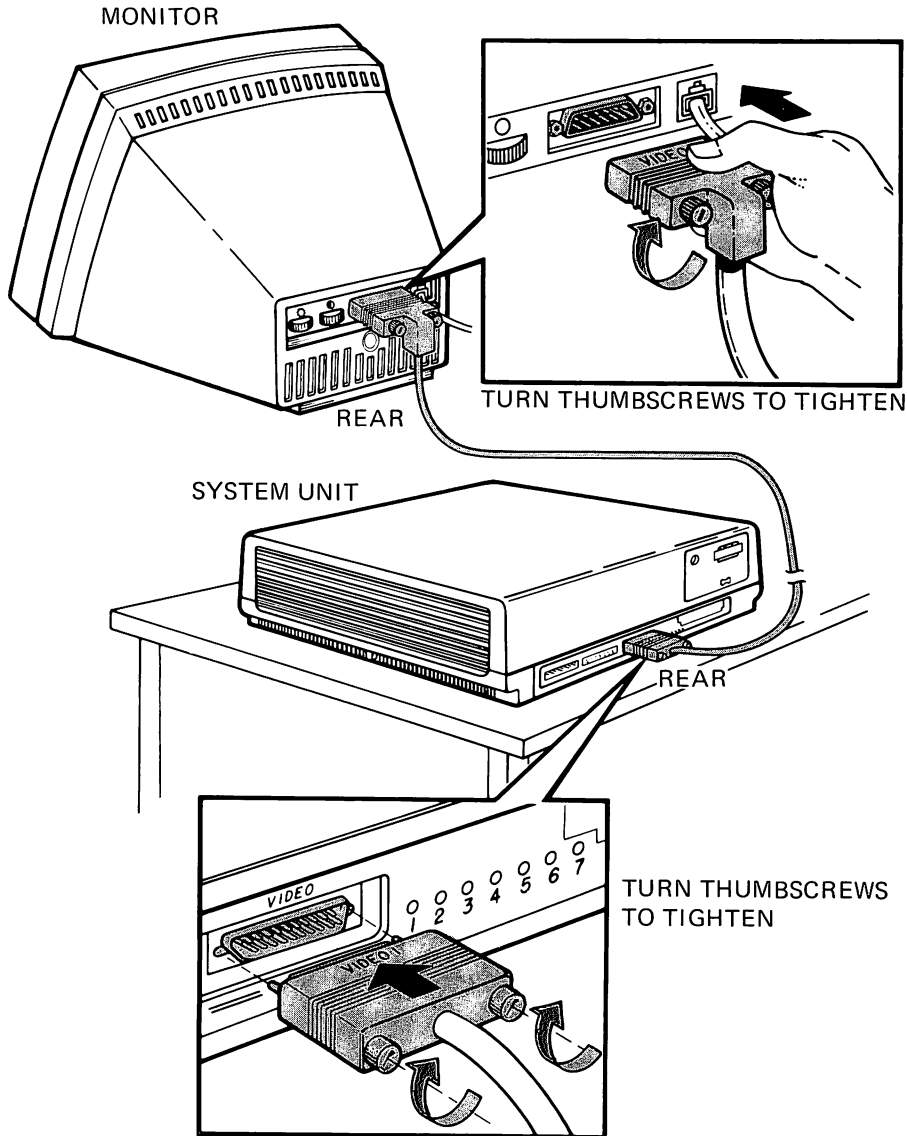

Open the top diskette drive door and remove the protective card from the diskette drive. Save this card.

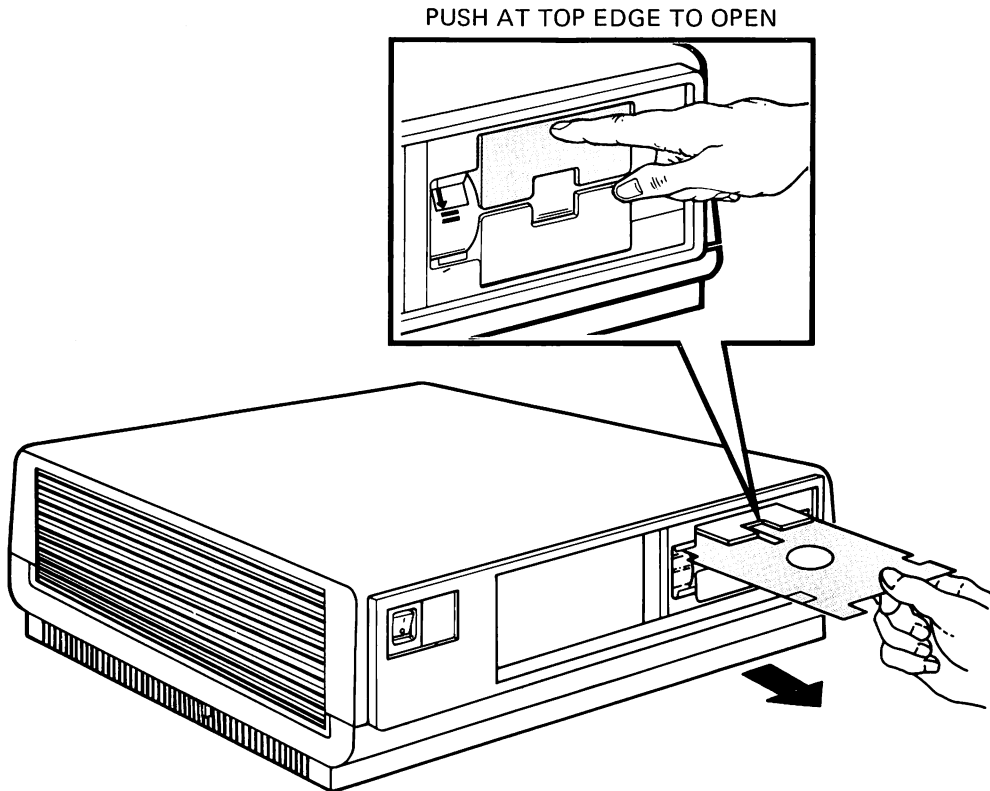

Label the diskette drives.

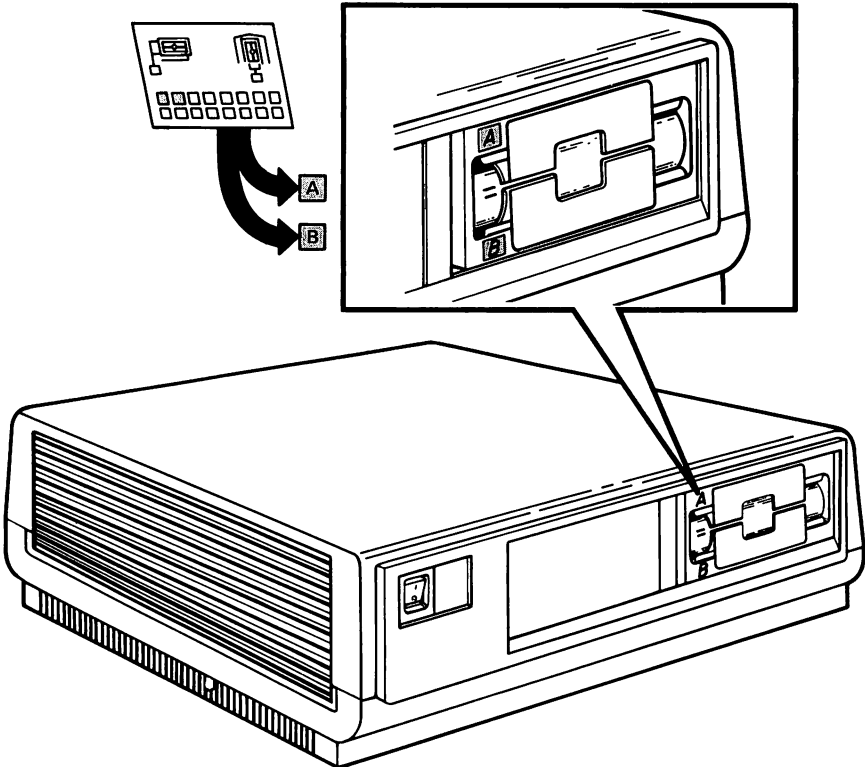

Set the power switch to 0 (off).

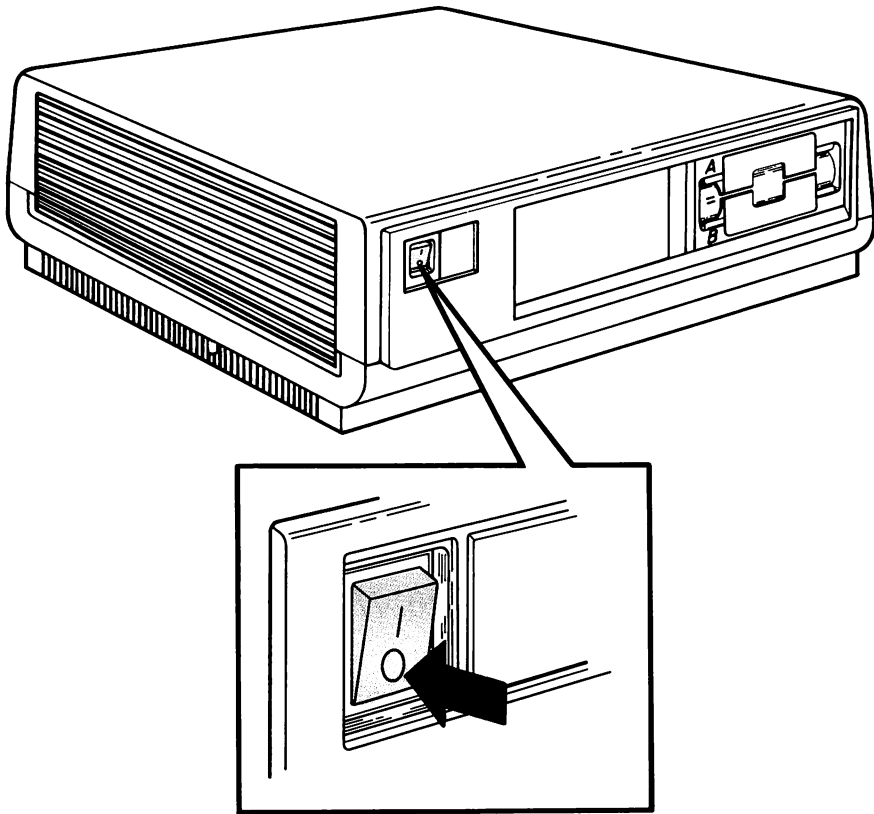

Identify the plug on the power cord.

Make sure that the plug on the power cord supplied matches that required for your wall receptacle.

NOTE

In North American countries, 115 volts is common;
230 volts is common in most other countries.

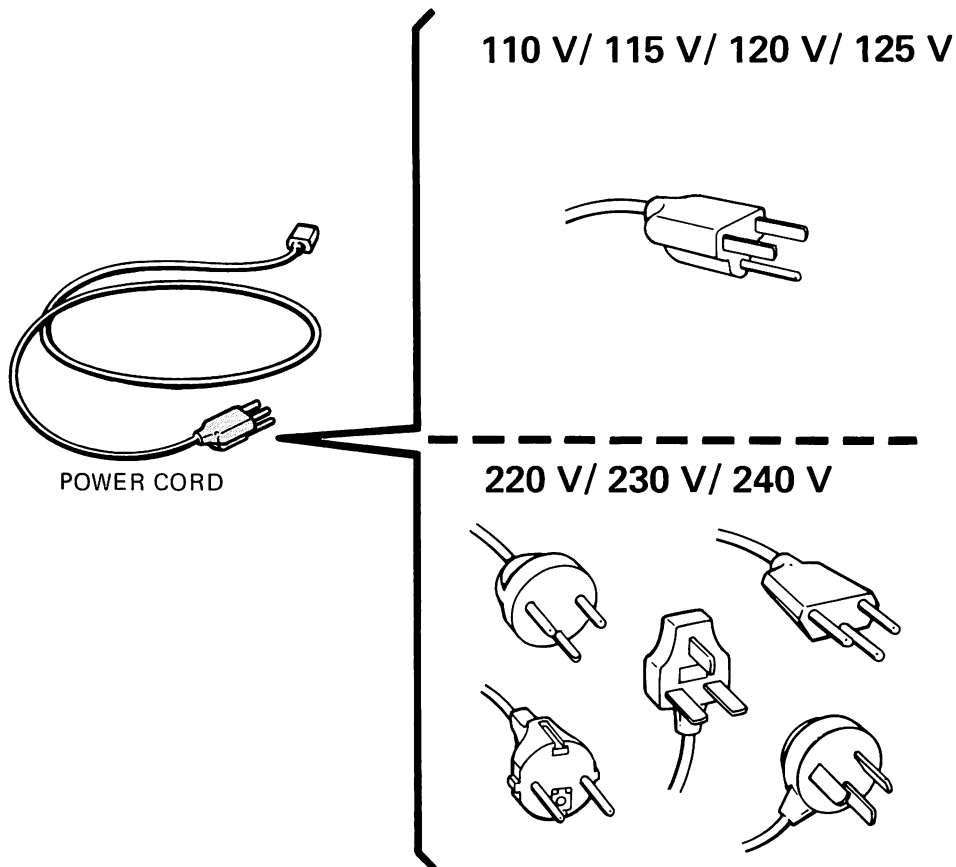

Check the voltage switch on the system unit.

CAUTION

An incorrect voltage setting can damage your computer.

NOTE

In North American countries, 115 volts is common; 230 volts is common in most other countries.

110 V/ 115 V/ 120 V/ 125 V

IN NORTH AMERICA THE SWITCH IS ALREADY SET TO 115 V

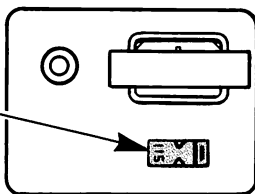

220 V/ 230 V/ 240 V

IN OTHER COUNTRIES, THE SWITCH SHOULD ALREADY BE SET TO 230 V. IF NOT, SLIDE SWITCH TO 230 V

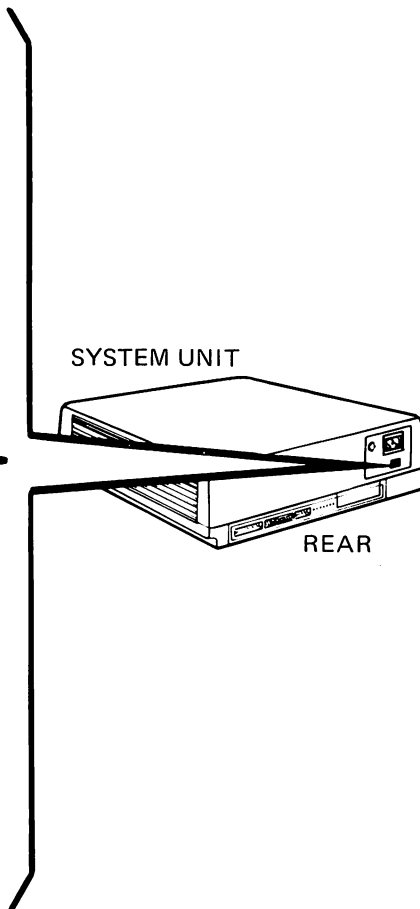
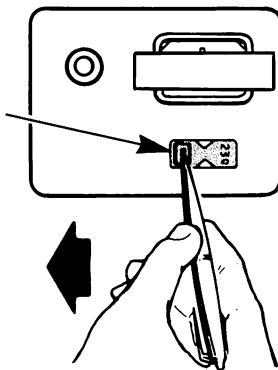

Remove the caution label and connect the power cord by plugging it firmly into the power connector.

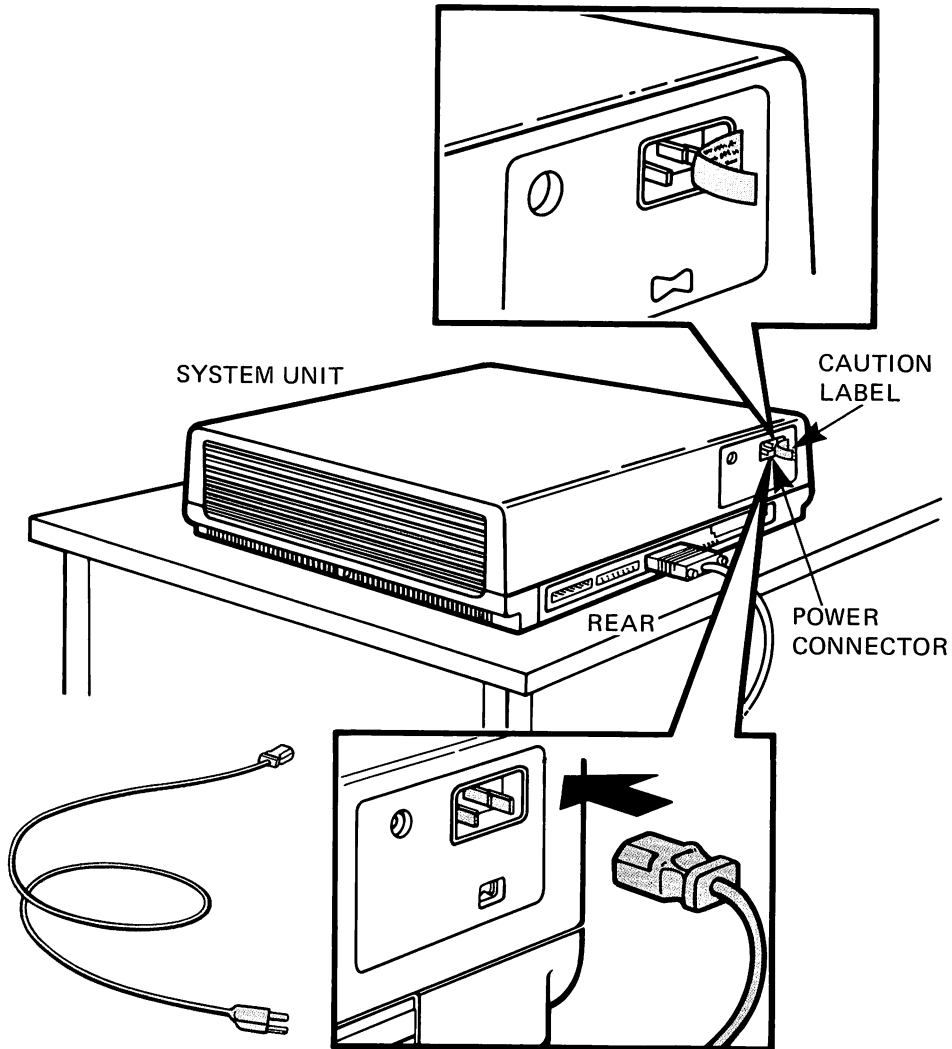

Plug in and turn on the Rainbow computer.

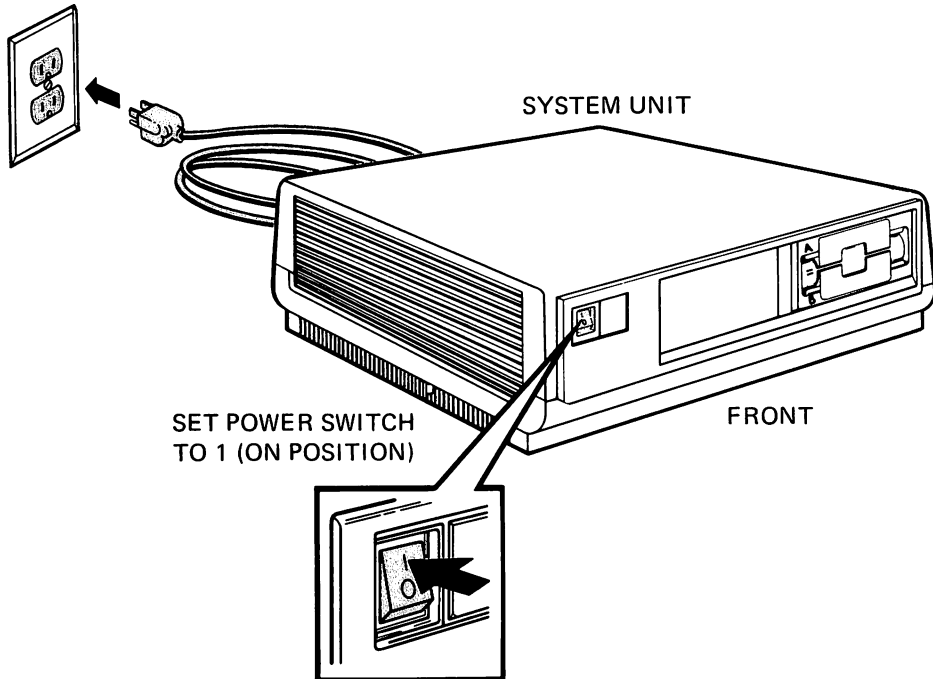

After about a minute, you will hear a whir and a beep; then you will see the Language Selection Menu.

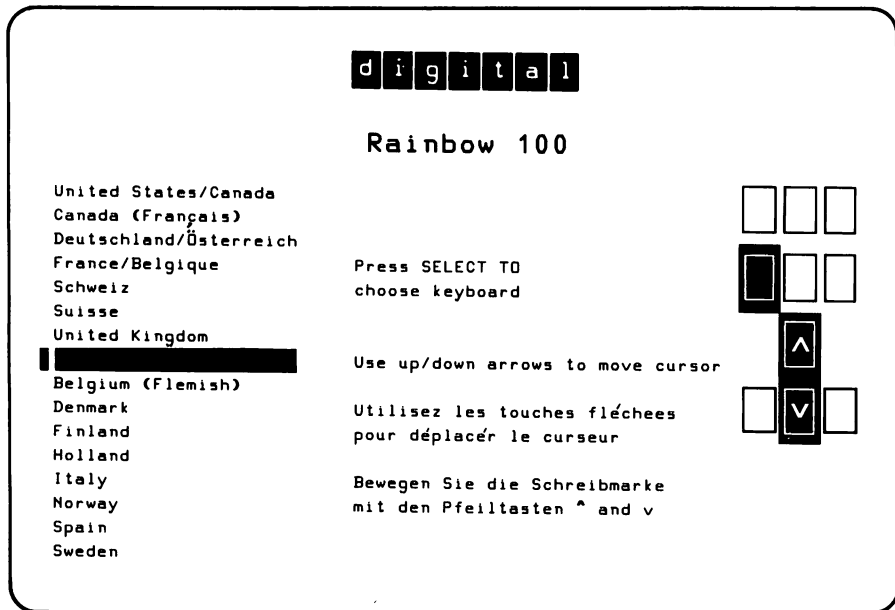

Adjust the brightness controls on the back of the monitor to eliminate any diagonal lines or white background.

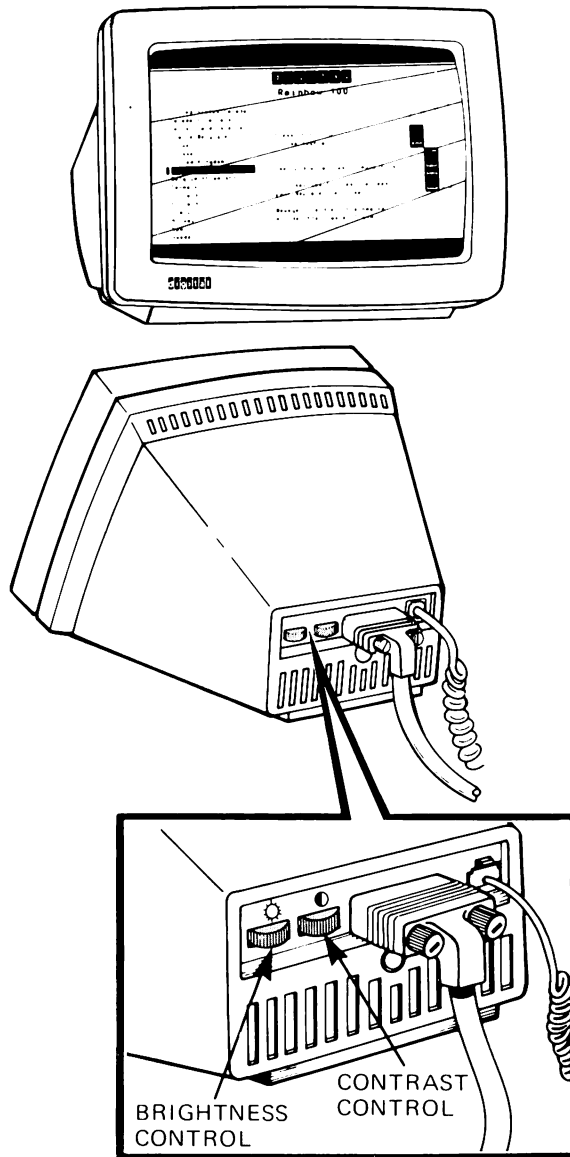

Select the language.

Press the **▲** or **▼** key as many times as needed to highlight the language desired.

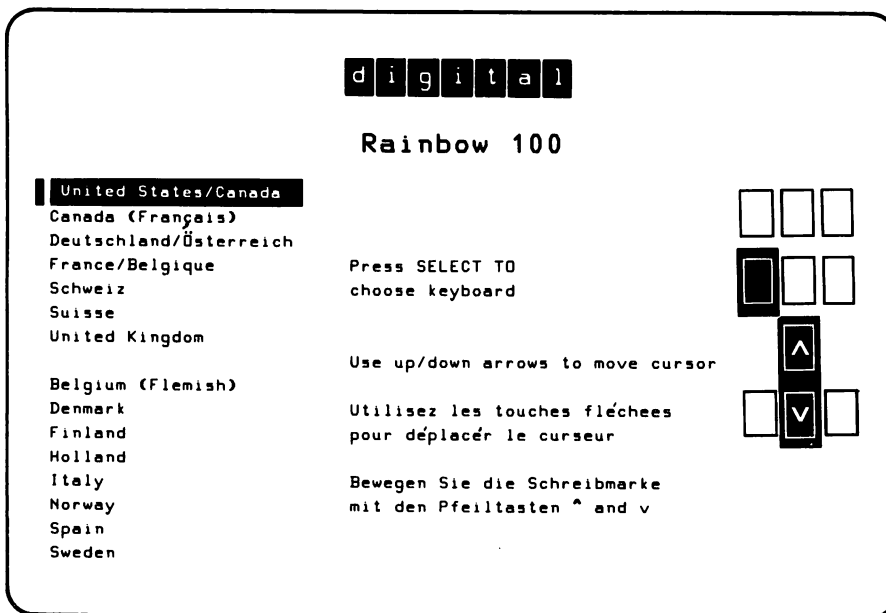

NOTE

If the Language Selection Menu is not displayed, press the keyboard keys in the following sequence to get this menu.

Set-Up

Shift/D

Shift/S

Hold down the **Ctrl** key and press the **Set-Up** key again.

After you have selected your language, press the Select key.

The Main System Menu is displayed.

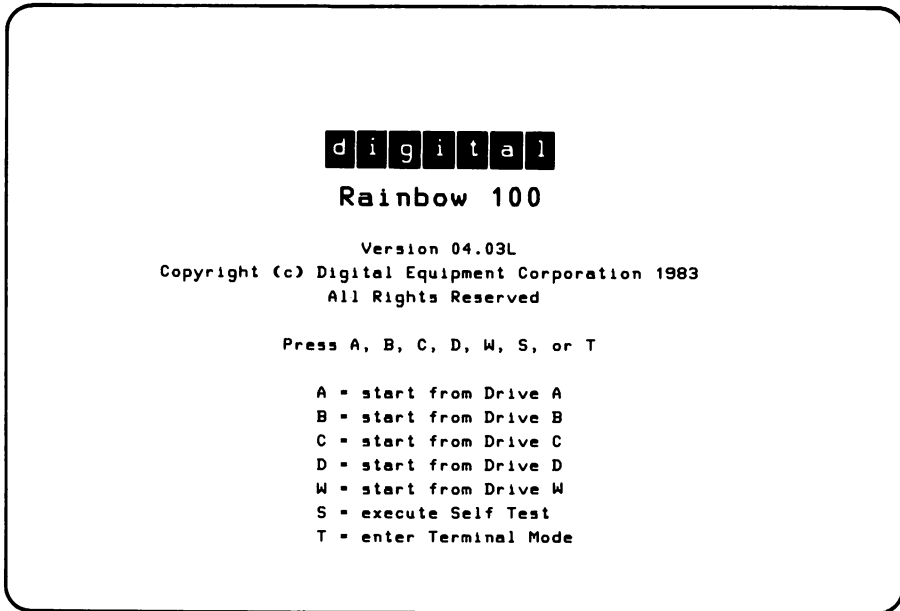

NOTE

The version number on your screen may be different than that shown here.

If you see a message at the top of the screen, turn to page 26 for help.

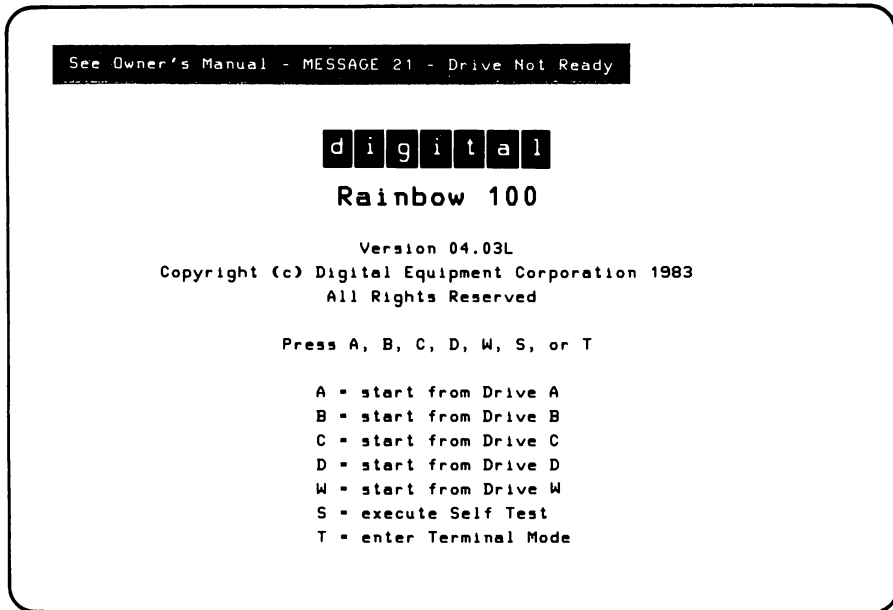

Find two blank diskettes.

NOTE

Part number BL-N402A-BK is printed on the blank diskette label.

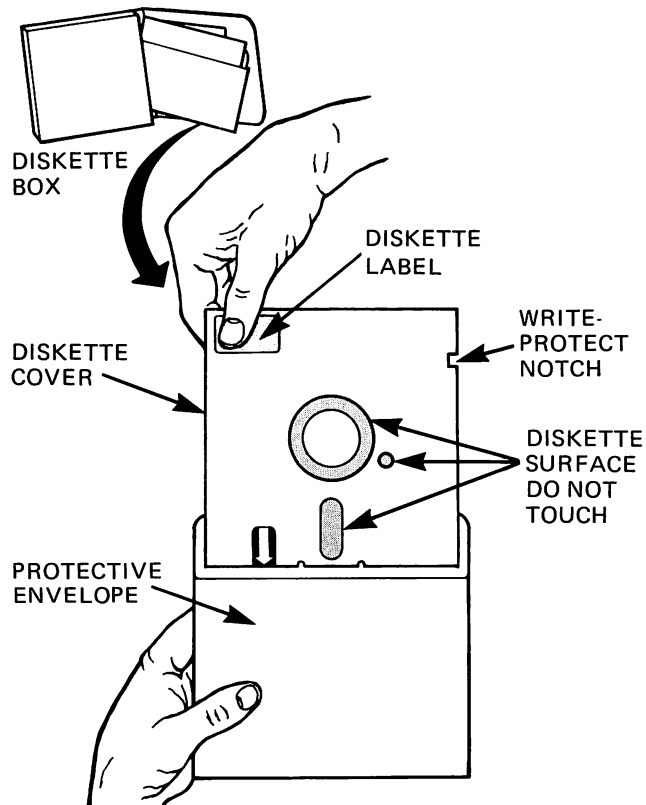

Insert diskettes.

- Open the doors on diskette drives A and B.
- With the diskette label **up**, insert a diskette in drive A.
- With the diskette label **down**, insert a diskette in drive B.

ALIGN ORANGE ARROW
ON DISKETTE WITH THE
ORANGE STRIPE ON
THE DISKETTE DRIVE

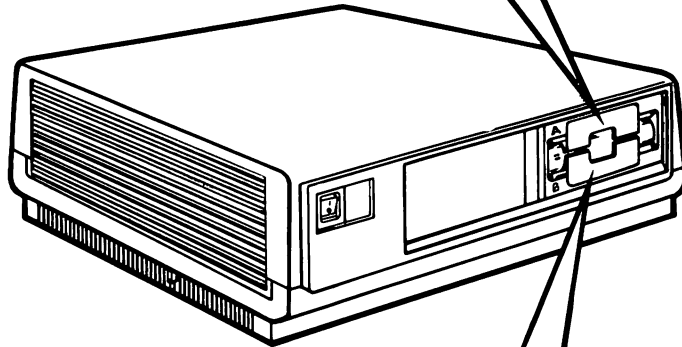
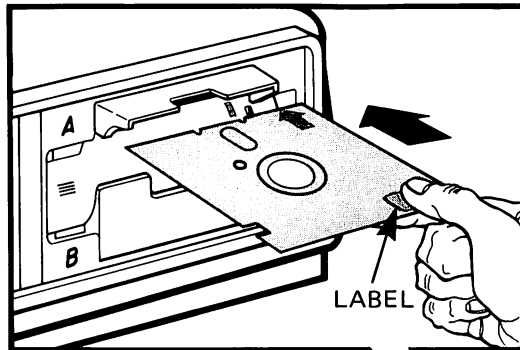

ALIGN ORANGE ARROW
ON DISKETTE WITH THE
ORANGE STRIPE ON
THE DISKETTE DRIVE

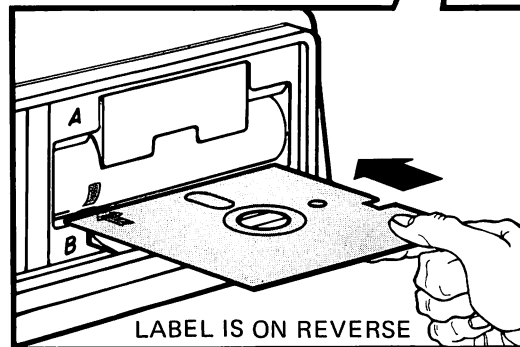

Press the S key on the keyboard to run the selftest.

TESTING . . .

is displayed on the screen.

After about a minute, you will hear a whir and a beep; then you will see the Main System Menu.

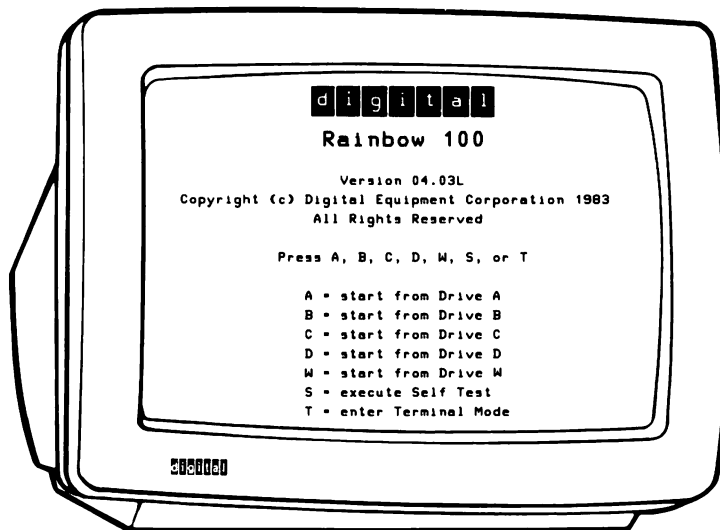

Take the diskettes out of the diskette drives.

**CONGRATULATIONS.
YOU HAVE SUCCESSFULLY INSTALLED
YOUR RAINBOW COMPUTER.**

When power is first turned on . . .

and one of the following messages is displayed, take the corrective action as indicated after each message.

See Owner's Manual - MESSAGE 12 - Drive A

Make sure the orange arrow on the diskette lines up with the orange stripe on diskette drive A. The diskette may be upside down.

Close the door on the diskette drive. Press S on the keyboard.

See Owner's Manual - MESSAGE 13 - Keyboard

Turn the power switch off. Make sure the keyboard cable is plugged in at both ends. Make sure that the thumbscrews on the monitor cable are tight. Turn the power switch on again.

See Owner's Manual - MESSAGE 21 - Drive Not Ready

You may have pressed a keyboard key by mistake; turn the power switch off, then on again.

If this message remains displayed, your Rainbow may be set to start automatically from a specific disk drive. Recall the default settings by pressing the following keys:

Set-Up

Shift/D

Shift/S

Hold down the **Ctrl** key and press the **Set-Up** key again.

Then return to page 21.

See Owner's Manual - MESSAGE 22 - Remove Card or Diskette

Remove the protective card or diskette from diskette drive A. Turn the power switch off, then on again.

During the selftest . . .

if one of the following messages is displayed, take the corrective action as indicated after each message.

See Owner's Manual - MESSAGE 23 - Nonsystem Diskette

You pressed **A** instead of **S**. Press **S** to run the selftest.

If a different message is displayed, look for the message and instructions in the message section of the *Rainbow™ Owner's Manual*. If you need help, press the **Help** key or call the Digital Customer Help Line number listed below.

Austria	(222)-67 76 41 extension 444
Australia	
Sydney	(02) 4112-5555
All other areas	(008) 226377
Belgium	(02) 24 26 790
Canada	(800) 267-5251
Denmark	(04) 30 10 05
Finland	(90) 42 33 32
France	(1) 687 31 52
Holland	(1820) 31 100
Norway	1-256422
Italy	(02) 617 53 81 or 617 53 82
Spain	(1) 73 34 307
Sweden	(08) 98 88 35
Switzerland	(01) 810 51 21
United Kingdom	(0256) 59 200
USA	(800) DEC-8000
West Germany	(089) 95 91 66 44

NOTE

If you do not use your Rainbow computer for more than 30 minutes, the display on the screen will disappear, leaving only a “phantom” cursor. This is the Auto-Screen Blank feature explained in the *Rainbow™ Owner's Manual*. If this happens, press the **Shift** key to cause the menu to reappear.

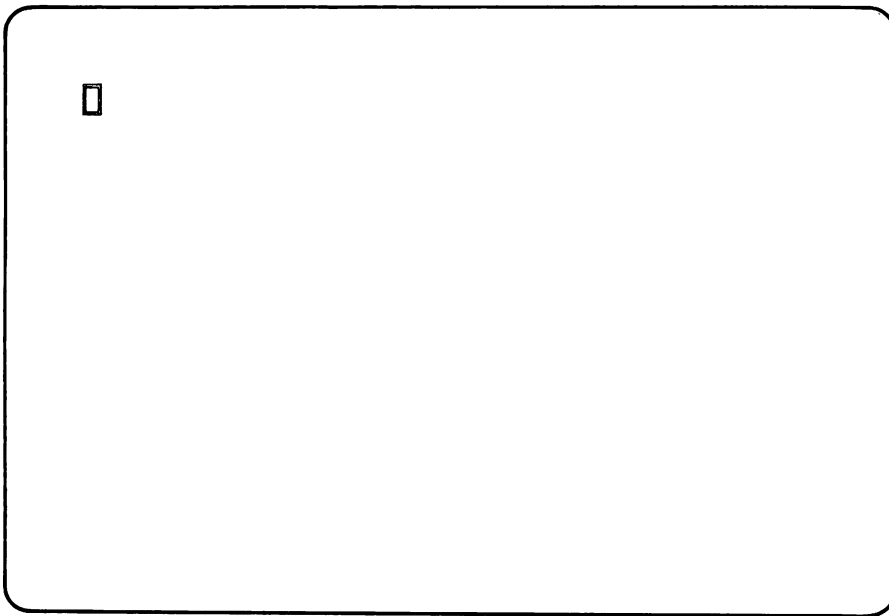

What to Do Next

First, install any additional equipment in the system unit.

A suggested order is as follows.

NOTE

Instructions are provided with each option.

- Install modules.

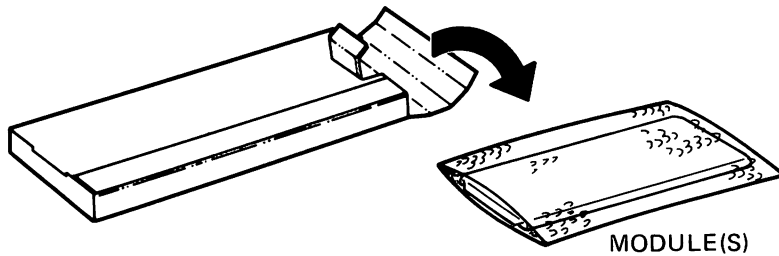

- Install a second diskette drive.

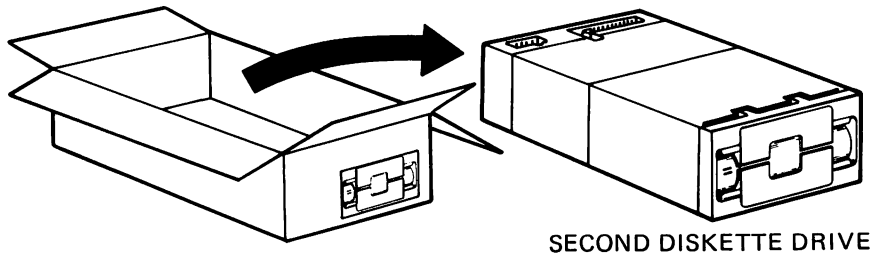

What to Do Next

- Install a hard disk drive.

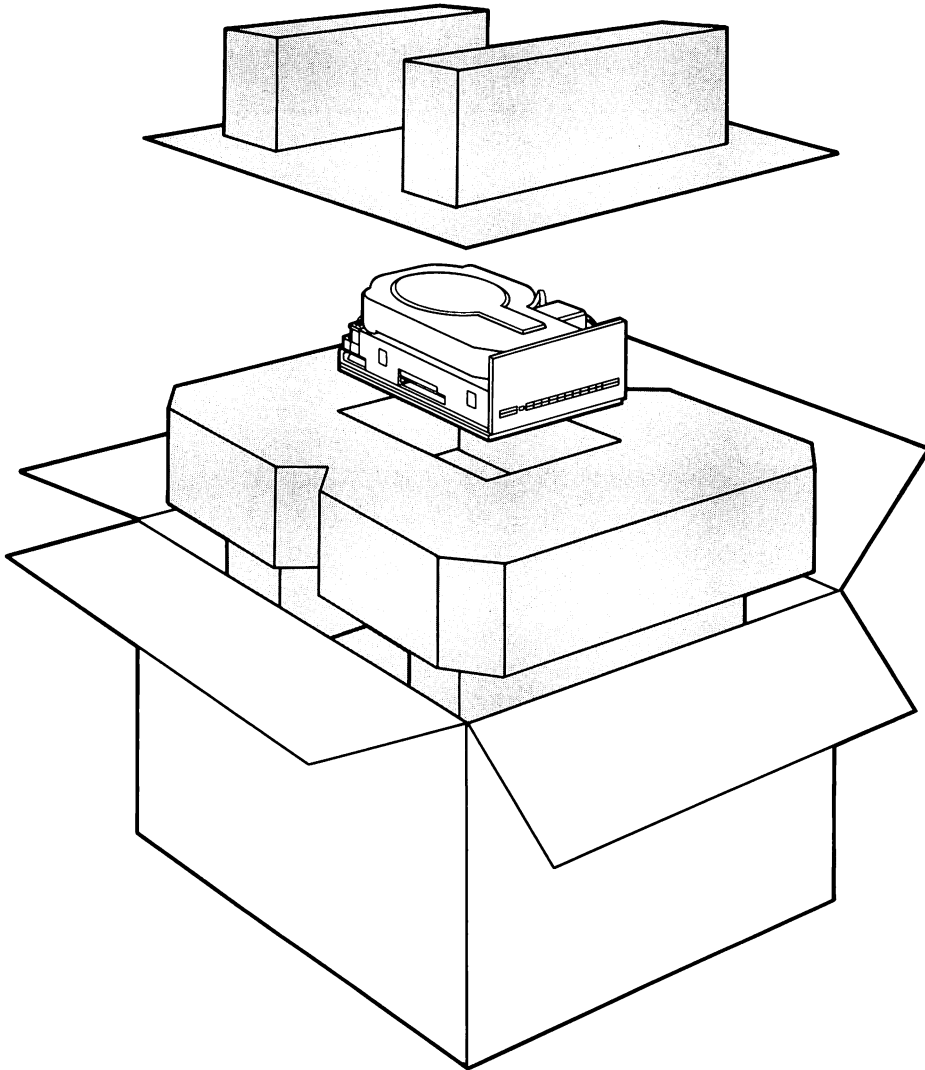

- Install the system unit in the floor stand.

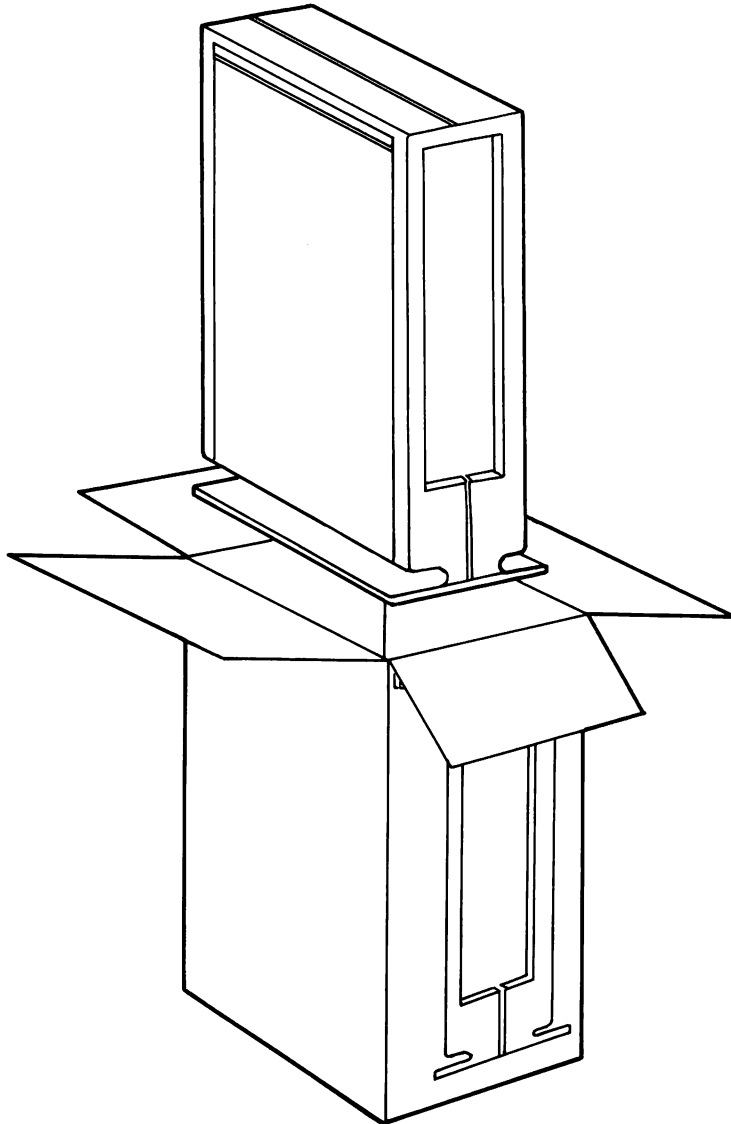

What to Do Next

- Install and connect the printer. Use the cable supplied with your Rainbow computer. Further information on printer set-up can be found in the *Rainbow™ Owner's Manual* and the instructions included with your printer.
- Then go to the *Rainbow™ Getting Started* manual to start the operating system.

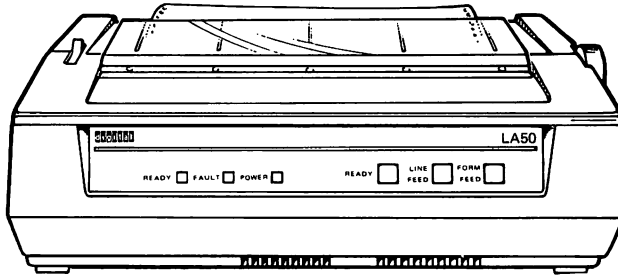

PRINTER

SYSTEM UNIT

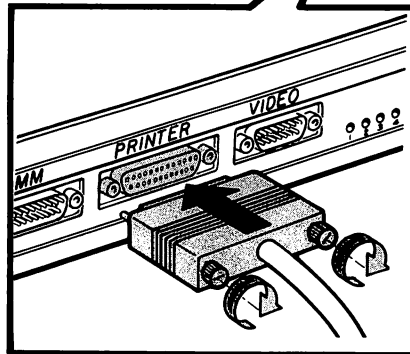
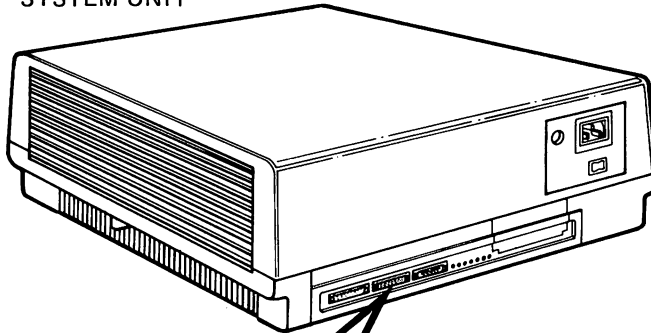

TURN THUMBSCREWS TO TIGHTEN

Packing Notes

Save this installation guide to help you disassemble, pack, and reassemble your system, if necessary. To ensure maximum protection when returning a unit to a service center for repair or to your dealer, do the following.

- Remove any hard disk drive and pack it in its original box. DO NOT transport the Rainbow with a hard disk drive installed. DO NOT transport the hard disk drive without its shipping box.
- Wrap any module in its original packing material and ship it in its original box.
- Pack the Rainbow monitor, system unit, or keyboard in their original box.

Should you need to move the computer to another office or to send it (or one of its diskette drives) to a service center for repair, remember to install the protective card in the top of each diskette drive to keep the moving parts in place. Install the protective card using the following steps.

1. Remove any diskettes from the diskette drives.
2. Set the 1/0 switch to 1 (on) and wait for a bell tone.
3. Set the 1/0 switch to 0 (off).
4. Insert a protective card in the top of each diskette drive (drive A and drive C, if present).
5. Close the doors on the diskette drives.

Date _____

READER'S COMMENTS

Did you find this manual understandable, usable, and well organized? Please make suggestions for improvement.

Did you find errors in this manual? If so, specify the errors and their page numbers.

How would you rate this manual?

- Excellent Good Fair Poor

Please check the boxes that most nearly describe your position.

- Management
 Nonmanagement
 Technical
 Nontechnical
 Other (please specify) _____

Name _____

Title _____

Company _____

Street _____ City _____

State _____ Zip Code _____ Country _____

Fold Here and Tape

digital



**No Postage
Necessary
if Mailed in the
United States**

BUSINESS REPLY MAIL
FIRST CLASS PERMIT NO 33 MAYNARD, MA

POSTAGE WILL BE PAID BY ADDRESSEE

DIGITAL EQUIPMENT CORPORATION
EDUCATIONAL SERVICES/QUALITY ASSURANCE
12 CROSBY DRIVE (BUO/E08)
BEDFORD, MA 01730

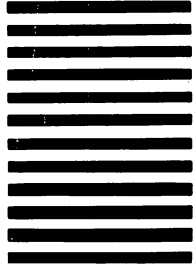

Fold Here